

FPPCX-ROX8R8T EURO-OEM8R8T

8 Transistor / 8 Relay
Output Expander



RINS1562-1



1) Opening the casing

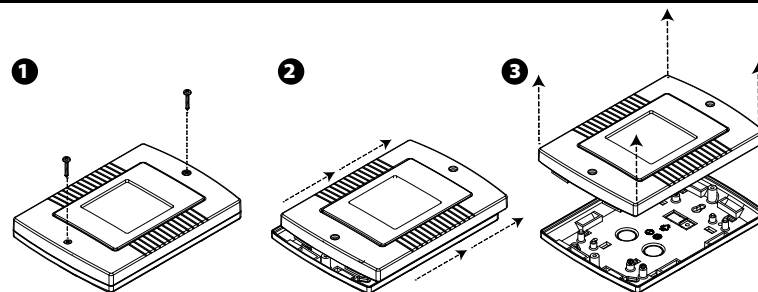

2) Stand Offs/Knock Outs

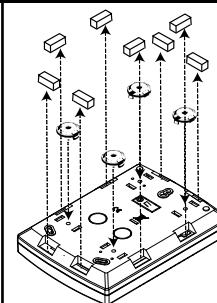

3) Rear Tamper

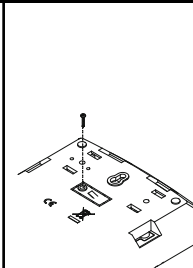

4) Label access

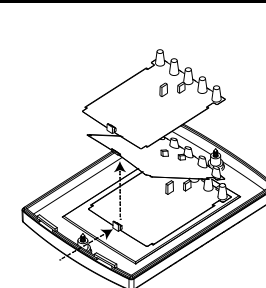

5) Relay Outputs (8 x)

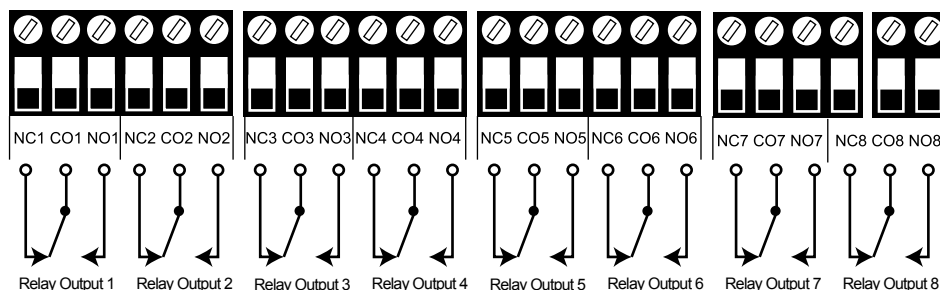

6) Transistor Outputs (8 x)

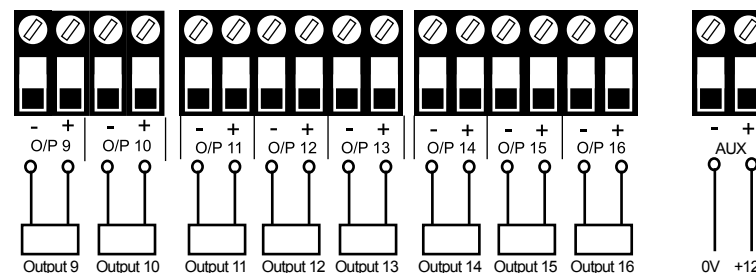

7) Output Status LEDs

Each Transistor and Relay LED will illuminate when the output is activated, and then distinguish when deactivated.

8) RS485 Bus Wiring

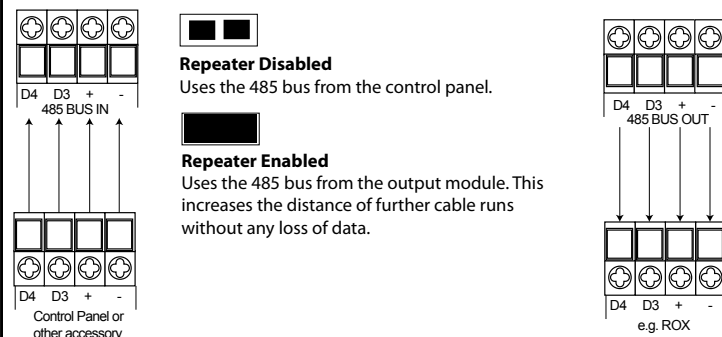

9) Status LEDs

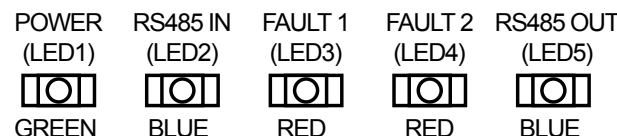

POWER LED ON: +12V supply

RS485 IN ON: Data "IN" OK

FAULT 1 ON: Data "IN" in fault

FAULT 2 ON: Data "OUT" in fault

RS485 OUT ON: Data "OUT" OK

NOTE: All LEDs will be disabled while the tamper switch is closed.

10) Addressing

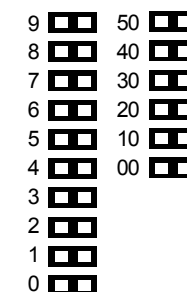

Address:
To address an output module, link out the headers as shown in the below example:

Address 04: 4 00
Address 12: 2 10
Address 20: 0 20

11) Operations

Tamper:
Disables the Tamper switch

Buzzer:
For future development

Engineer Keypad:
An engineer keypad can be connected here giving access to the engineers mode. NOTE: The keypad must be addressed before use.

12) Compliance

For electrical products sold within the European Community. At the end of the electrical products useful life, it should not be disposed of with household waste. Please recycle where facilities exist. Check with your Local Authority or retailer for recycling advice in your country.



Suitable for use in systems installed to PD6662:2010, EN50131-1:2006+A1:2009 at Security Grade 3, Environmental Class II. Subject to the grading of the overall system.

13) Technical Specification

Input Voltages	10.5V to 15V DC
Max Current Consump.	350mA (Quiescent Current: 25mA)
Open-collector outputs	(#9 - #14): <100mA each, max. combined 500mA
Open-drain outputs	(#15 & #16) 1A each (continuous)
Relay Outputs	3A
Dimensions	173 x 125 x 32mm
Operational	-10°C to +40°C, (14°F to 104°F)
Storage	-20°C to +60°C, (4°F to 140°F)
Humidity	85% @ 25°C
Weight	0.24kg

14) Warranty

This product is sold subject to our standard warranty against defects in workmanship for a period of two years. In the interest of continuing improvement of quality, customer care and design, Pyronix Ltd reserve the right to amend specifications without giving prior notice.

15) Customer Support

Customer Support Line: 0845 6434 999 (local rate) or call +44(0)1709 535225

Hours: 8.00am - 6.30pm, Monday to Friday

customer.support@pyronix.com
marketing@pyronix.com

www.pyronix.com

Pyronix Ltd, Secure House, Braithwell Way, Hellaby, Rotherham, S66 8QY, UK