



FEATURES:

- Aluminum alloy material with surface spray treatment
- Waterproof design

DS-1280ZJ-M/G

SPEC

Parameters	Junction box
Colour	Hik Grey
Feature	Suitable for DS-2CE56D7T-IT3Z/G
Material	Aluminum Alloy
Dimension	Ø157 x 51.5 x 185mm
Weight	621g

INFORMATION:

- The bracket should be installed on a flat wall
- The wall must be capable of supporting over 3 times as much as the total weight of the camera and the mount
- The maximum load capacity of the bracket is 4.5kg
- Waterproof ribber is necessary for outdoor application

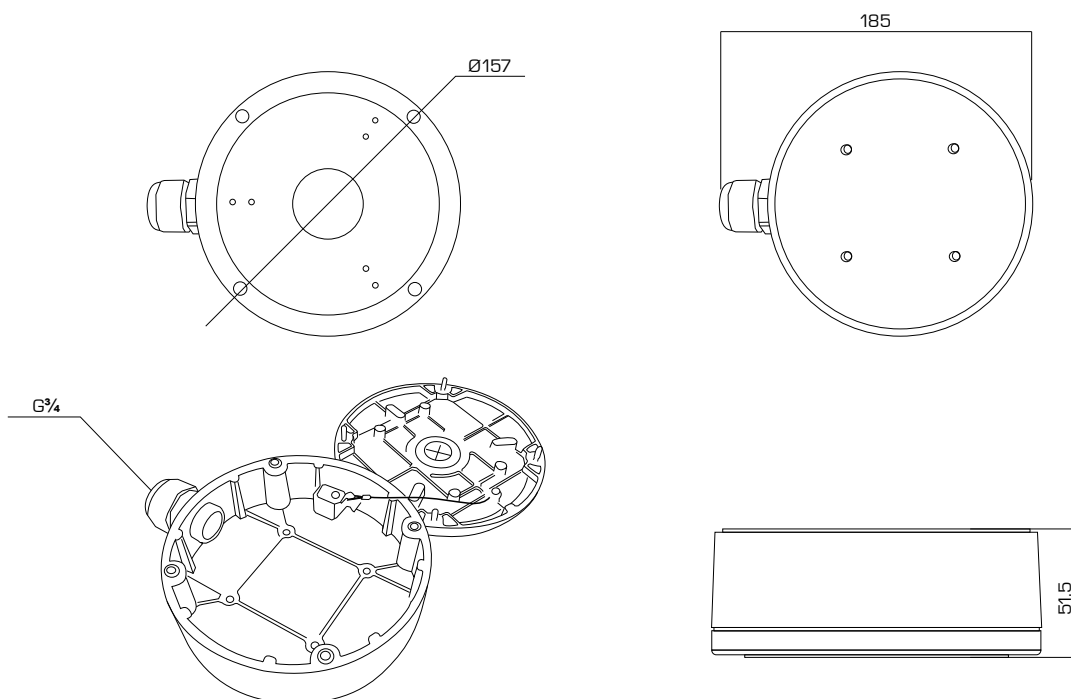

unit: mm